

Enigma Veyron Power Amplifier User Guide

EV-MP1000-1.0

Table of content

3	Preface
4	Introduction to the Enigma Veyron System
6	Part list
7	Unpacking
10	Installation
13	Connection
17	Optimization
18	Specifications
19	Dimensions
20	Warranty

Preface

Congratulations,

You are now the proud owner of the Kharma Enigma Power Amplifier. Your new amplifier, properly installed, will give you all the satisfaction and enjoyment you expect from Kharma.

As with any high quality product, special care must be taken to install your amplifier. Please read this manual carefully and totally prior to installation.

Important Please read the manual thoroughly before taking further steps.

Introduction to the Enigma Veyron

Above and beyond imagination has always been the core value of Kharma, which now results in the Kharma Enigma Veyron System. Charles van Oosterum has created the Enigma Veyron System on his journey to create the ultimate audio experience. He has combined technology, experience and knowledge to uplift sound representation to an unknown level of synergy.

The Kharma Enigma Veyron system is the most advanced audio system in the world realizing the Holy Grail in the High-end audio. To create a new level of sound quality and truly offer superior technology that would push the limits of current dynamic loudspeakers was not an easy task. This time fully new engineered Kharma drivers are the basis of the Enigma Veyron, as well as a new cabinet, materials, internal cable technology and more. We decided to offer the whole package to drive the full Enigma Veyron as well. New wide band linear power amps, a complete new touchscreen operated pre-amp, App controlled subwoofer management and massive power distributors as well as a diamond suspended audio rack were developed. Hence many exciting innovations were developed by Kharma to create this unique audio system.

The bass and midrange section of the Veyron are formed by the exclusive Kharma Omega 7-F Drivers. The F stands for 0-Foucault currents, which is a novelty in the audio world, because for the first time no iron is used in the magnet motor-system, avoiding any interaction. Normally the voice coil induces a Foucault-current into the iron parts and that current induces back distortion into the driver-coil which will distort the original signal by definition. This is now completely gone and the result is a higher resolution, more micro-dynamics, more macro-dynamics, faster transients, more richer spectrum of tonal variations from the music itself, more natural sounding, more explosive sounding, more realistic sounding.

Moreover, Kharma created the largest Diamond cone surface ever used in a loudspeaker. To create extreme resolution and dispersion for the upper mid and lower high frequency Kharma has used 4 x 50 mm diamond tweeters. For the ultimate clear high frequencies, far beyond hearing, four Diamond tweeters of 25 mm are being used. These 8 tweeters with a combined surface of around 400 square centimeters are just for one loudspeaker.

The Enigma Veyron System has magical physical dimensions, which are as impressive as the musical performance this loudspeaker has to offer. The loudspeaker cabinets are constructed from 100 mm thick Bullet wood panels and the audio rack and electronics from 38 mm thick aluminium plates. Although the constructions are massive but elegant, all components are decoupled from the surrounding by a minimum contact surface created with Tungsten balls placed on Diamonds. The combination of the hardness, shape and acoustical properties of the materials used, realize the ultimate freedom of resonances.

Kharma has pushed the limits for each component of the Enigma Veyron system. The sound representation and aesthetical beauty is overwhelming and certainly beyond imagination.

Part list

Each crate contains:

- 1 x Enigma Veyron Mono Power Amplifier*
- 4 x Stand Disc with single or triple Diamond**
- 1 x Power cord
- 1 x Manual

* Dependent on your audio rack configuration, the crate contains the bottom level or top level of the Enigma Veyron Amplifier.

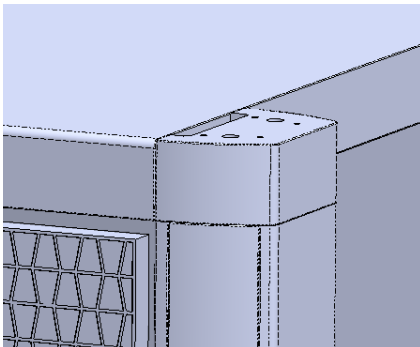

Bottom Level Amplifier

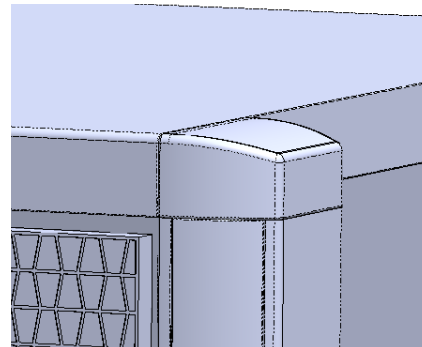

Top Level Amplifier

** When more than one rack is stacked on top of the Amplifier, the Amplifier will be delivered with a stand disc with triple Diamonds. This is to prevent the Diamond discs to crack under the total weight of the audio rack and equipment combined. The other levels will have a stand disc with single Diamond.

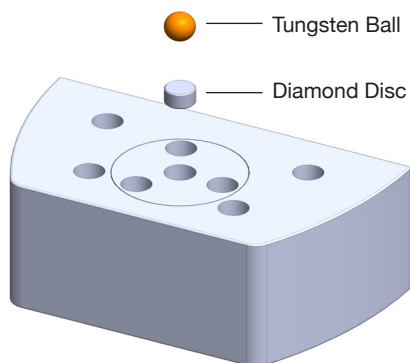

Single Diamond Stand

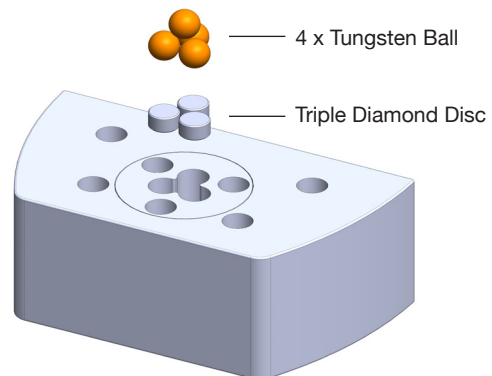

Triple Diamond Stand

Unpacking

Opening the crate

Upon opening the crate, inspect the crate carefully for any sign of transport damage. If there is damage, immediately call your dealer or the trucking firm that made the delivery. Do not delay in reporting the damage. Please store the crates for future use.

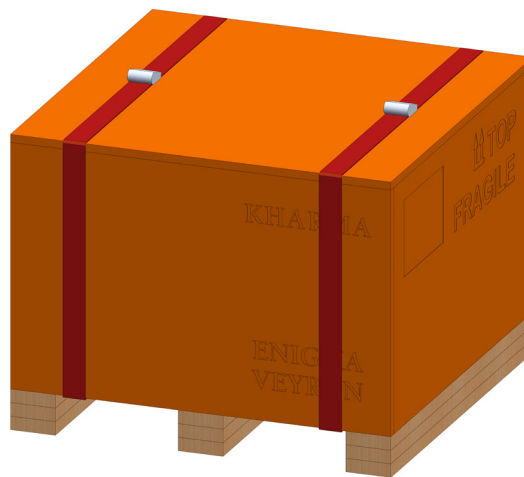

Step 1: Remove top cover

Note: Read the manual before further installation

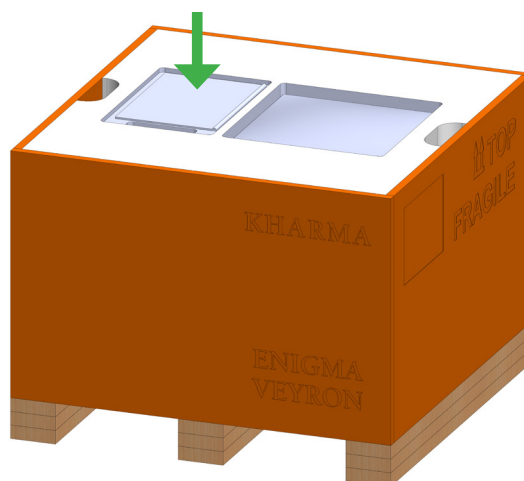

Step 2: Remove the Stand discs

The stand discs will be executed with a single or triple Diamond, dependent on the configuration of the audio rack. The Tungsten Balls are packed separately, where the Diamond discs are already placed in the aluminium discs. Please prepare the discs as shown on page 6.

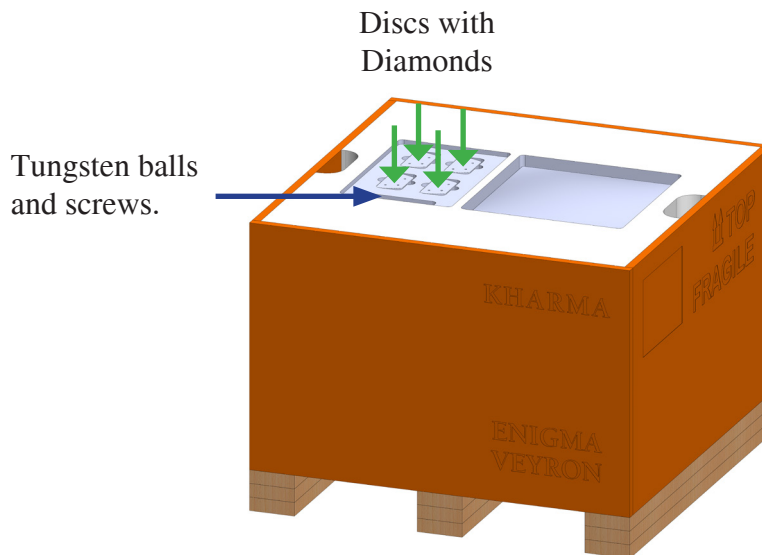

Step 3: Remove foam cover

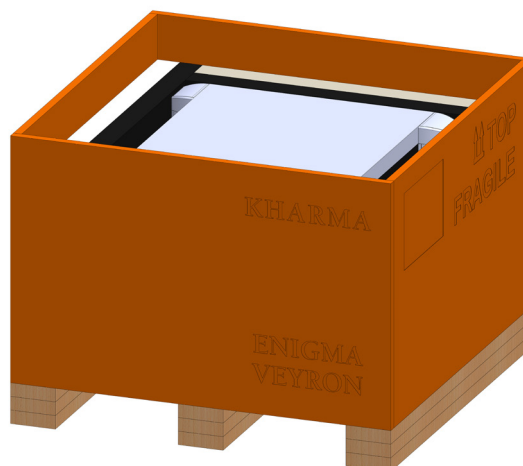

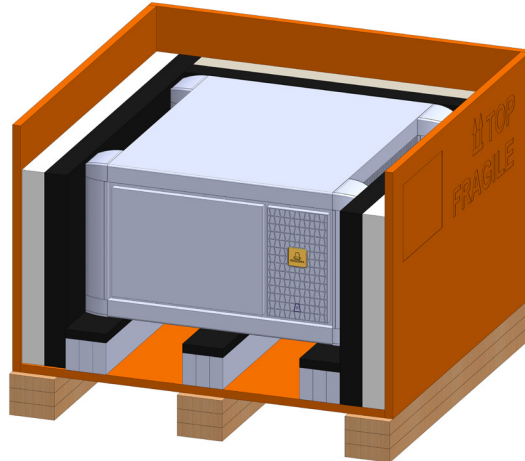
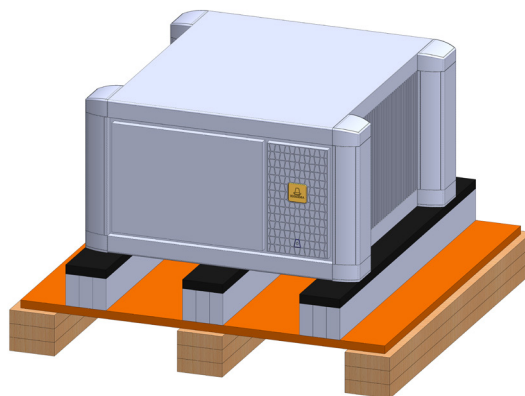
Step 4: Unscrew front panel**Step 5: Unscrew all panels****Step 6: Lift rack from pallet**

The openings underneath the rack can be used in combination with a hoist structure. Please always use protective foam between the lift construction and rack.

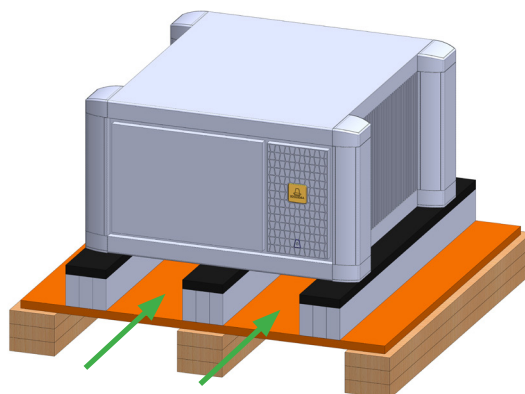

Installation

The Enigma Veyron Amplifier is a part of the modular Enigma Veyron Audio Rack levels. Each level should be positioned carefully and precise. This because all levels will have to be placed on Diamond discs, which have a small surface and can not handle high impact.

Important

The Diamond discs may not be exposed to high impact. The Diamonds can only handle continuous load.

Step 1: Place rack carefully on Diamond Stands.

Please make sure the Triple Diamond Stands are being used for the bottom level. This is to prevent the Diamond discs to crack under the total weight of the audio rack and equipment combined.

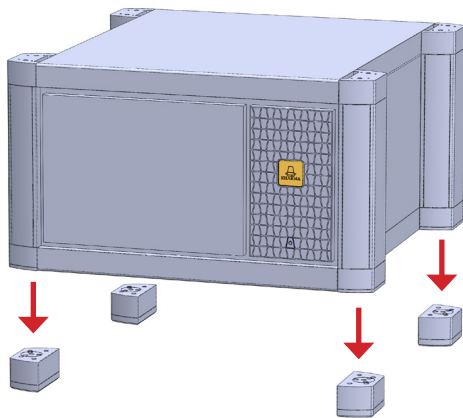

Basic installation: lower the rack on the stand

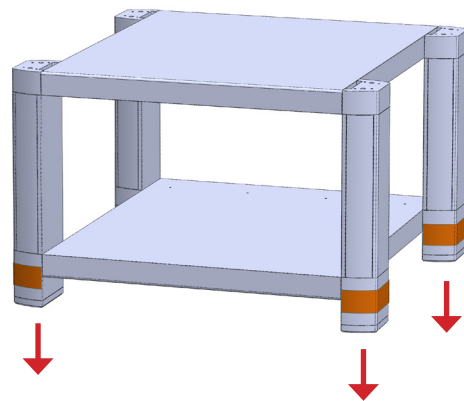

Tip: Tape the stand to the rack level and lower the entire level at once

Important

Make sure you put the tungsten balls on the Diamond discs before lowering the rack on the stands.

Note: When the Audio Rack is consisting of less than 3 levels, single Diamond Stands are being provided.

Important

Although the Diamond stands have a floor protector with felt for the bottom level, do not try to reposition the rack after placing the rack on the Diamond discs. The discs should be removed again before repositioning.

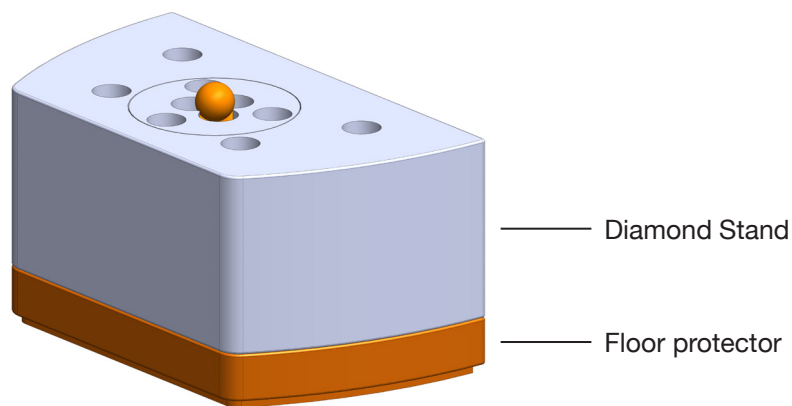

Step 2: Assemble stands for second level

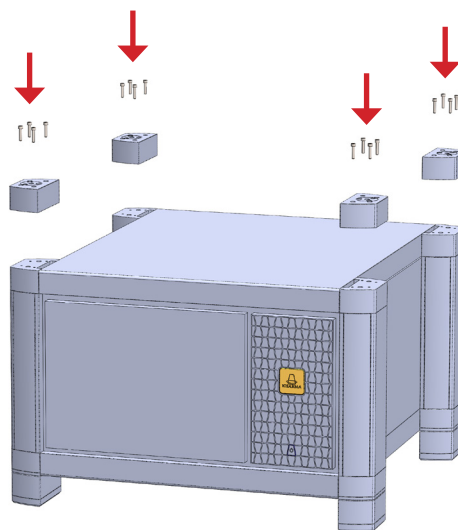
A second level can be placed on top of the bottom level by screwing the Diamond Stands (delivered with the second level) on the bottom level.

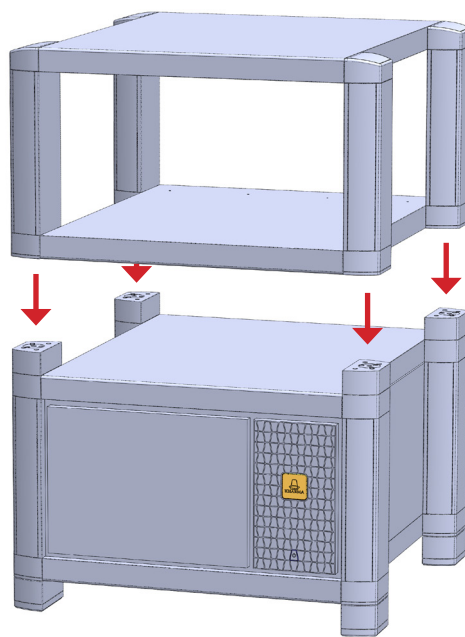

Step 3: Place new level

When the audio rack is consisting of 2 levels, slowly lower the rack on top of the Diamond Stands. When a third level is required repeat from step 2.

**Important**

Make sure you put the tungsten balls on the Diamond discs before lowering the rack on the stands.

Connection

At the rear of the Enigma Veyron Amplifier all connectors can be found. The rear side can be generally divided into three panels: input, power and output panel. Moreover, backlight can be created by using the switch of the panel light.

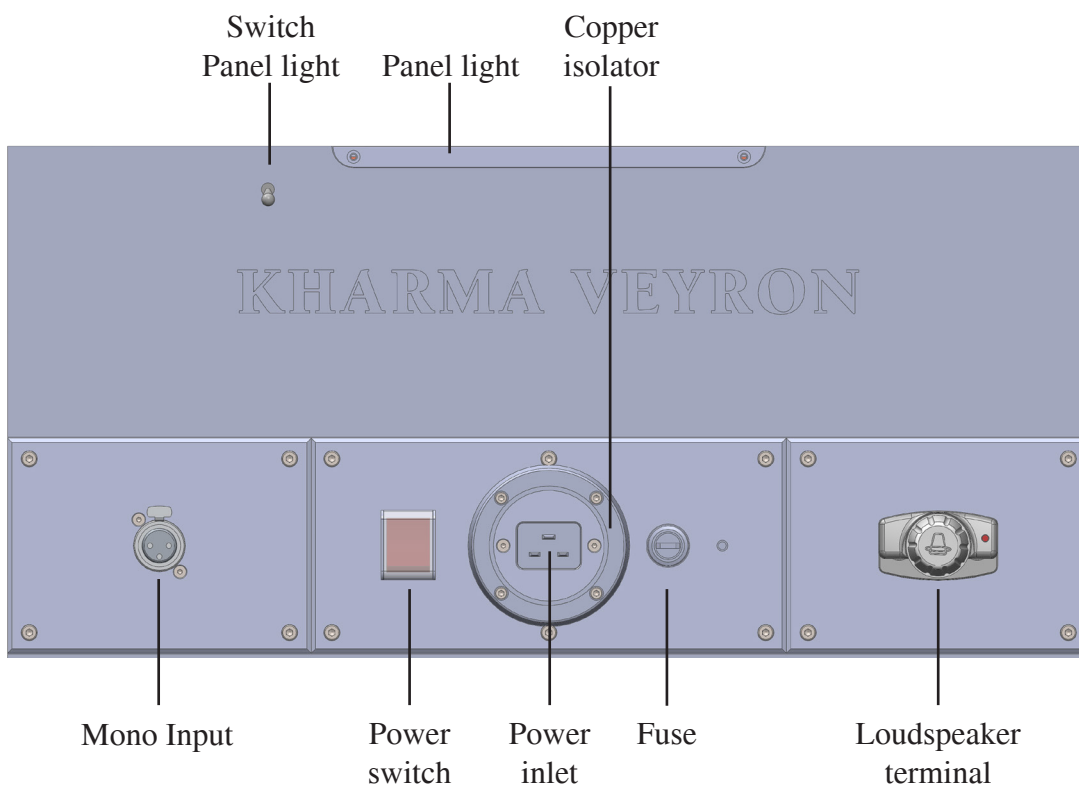

BE CAREFUL to connect your power cord to a 115V or 230V power source depending on the configuration of the Amplifier! If you are not sure about the voltage to which your Amplifier is configured please contact your dealer. **DO NOT** switch on the power until all wiring is connected correctly!

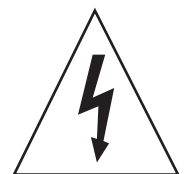

The Amplifier power inlet is supplied with a gold plated copper isolator. For the best sound quality it is preferred to leave this isolator on the Amplifier. However some power cords are too big and make it impossible to use the isolator.

Powering the Amplifier

Connect a power-cord to the power inlet on the back of the Amplifier. Switch on the Amplifier using the red button on the back side. The Amplifier is on when the red button is lit.

Always turn off the power of your entire system before making connections to the Amplifier. It is advised to turn off the Amplifier when not used for a long time e.g. during holidays.

Activating the Amplifier

At the front of the Amplifier a trapezium button with LED indication can be found. When the power switch at the back of the Amplifier is turned on, the button illustrated below, will turn orange.

To activate the Amplifier press the button (for less than one second). It will take a few seconds before the LED indicator will turn blue and the Amplifier is in operating mode.

When you want to put the Amplifier back in 'standby' mode, keep the button pressed till the indicator light turns to orange. Please only use the power switch at the back side when it will not be used for a longer time.

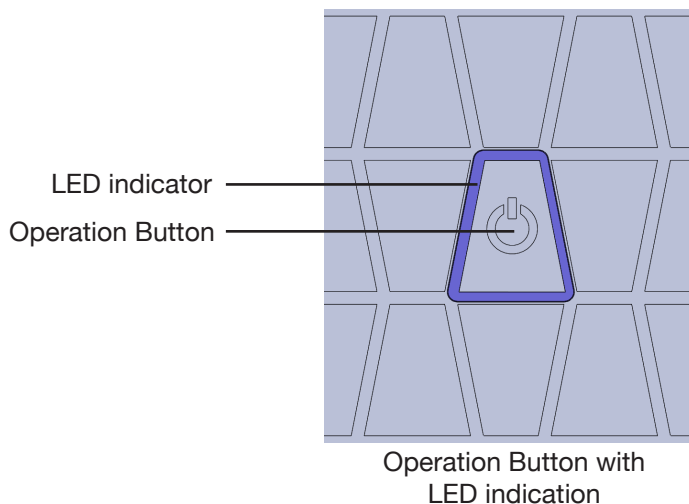

Muting the Amplifier

The trapezium button can also be used as a mute button when the Amplifier is in operating mode. Hold down the button for less than one second. The indicator light will turn to green. The Amplifier will remain fully operational, only the sound is turned off. To turn off the mute function, simply press the button again.

Fault conditions

There are three fault conditions that can occur. The indicator light will show the fault condition with a particular colour. When an error occurs, the Amplifier will stay locked in error detected mode and the Amplifier must be reset using the power switch at the back. There is a time delay on this switch to prevent switching the Amplifier on/off too fast.

When the indicator light turns red, the maximum current limit is crossed. The reason for this can be a short circuit or just playing too loud.

When the indicator light turns purple, a DC-current is detected and the Amplifier turns off to protect the loudspeaker that is connected.

When the indicator light turns white, the main power is lost or below the necessary voltage for a short period of time.

Panic button

The power switch on the backside can always be used as a panic button. In case of emergency simply use the switch and the Amplifier will turn off completely.

Operating summary

Colour scheme - Indicator lights:

Colour	Indication
Off	Power switched off
Orange	Standby mode
Blue	Operating mode
Green	Mute mode
Red	Maximum current limit is crossed, please turn off the amplifier
Purple	DC-current detected, please turn off the amplifier
White	Main power too low

Mode scheme - Possible actions:

Mode	Action	Result
Off	Use power switch on backside of the Amplifier	Standby mode
On	Use power switch on backside of the Amplifier	Amplifier off
Standby	Hold down button for less then 1 second	Operating mode
Operating	Hold down button until indicator light turns orange	Standby mode
Operating	Hold down button for less then 1 second	Mute mode
Mute	Hold down button for less then 1 second	Operating mode

Optimization

Burn-In

The Enigma Veyron Amplifier needs quite a bit of playing time to reach maximum result. The use of a Burn-in test-CD is recommended to speed up this process. With a “burn-in” test CD like the XLO or Sheffield-lab CD, burn-in time is reduced to approximately 50 hours. After burning-in your system, you can play demagnetizing tracks for maximum clarity. Your system will then be optimised and sound more open, more detailed and will display a more natural musical warmth.

Taking care of your Amplifier

Use a soft cloth and a spray-cleaner to clean the surface and wood-sides. No further care is necessary.

In event of trouble

If the Enigma Veyron Amplifier produces distorted sound, no sound at all or seems to be malfunctioning otherwise, determine if the problem is in the Amplifier or one of your other components.

- If one channel malfunctions, try switching the loudspeakers. If the problem occurs on the other channel this time, it is probably your loudspeaker that is malfunctioning.
- Switch the connections at your pre-amplifier: connect the Amplifier that was connected to the right channel to the left, and the left to the right. If the same channel is distorted it is probably one of your other audio components.

When the problem seems to be in the Enigma Veyron Amplifier, turn off the system and disconnect the Amplifier. Consult the Authorized Kharma-dealer from whom you have purchased the system. Kharma Dealers are audio specialists and can be of great assistance.

Important

Do not attempt to repair the Enigma Veyron Amplifier yourself. You will lose your warranty on the product.

Specifications

Type:	Linear Amplifier Technology
Rated power:	400 Watt at 8 Ohm 800 Watt at 4 Ohm
Peak power:	2700 Watt
Freq. Range:	4 Hz - 200 kHz
Output impedance:	0 Ohm
Input impedance:	10 kOhm
Damping factor:	Infinite
THD + N:	-120 dB
IMD:	-120 dB
Input connections:	XLR or RCA
Output connections:	Spades

Dimensions

Dimensions Bottom Level

Height	388 mm / 15.3 inch
Width	610 mm / 24.0 inch
Depth	600 mm / 23.6 inch

Dimensions Single Level

Height	376 mm / 14.8 inch
Width	610 mm / 24.0 inch
Depth	600 mm / 23.6 inch

Nett weight **175 kg / 386 lbs**

Note: The bottom level has a different height, because there is an additional block screwed under the stands. This block has felt to protect the floor from scratches.

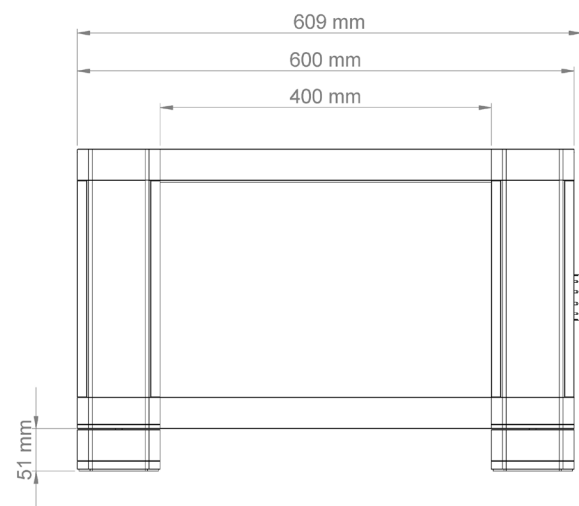
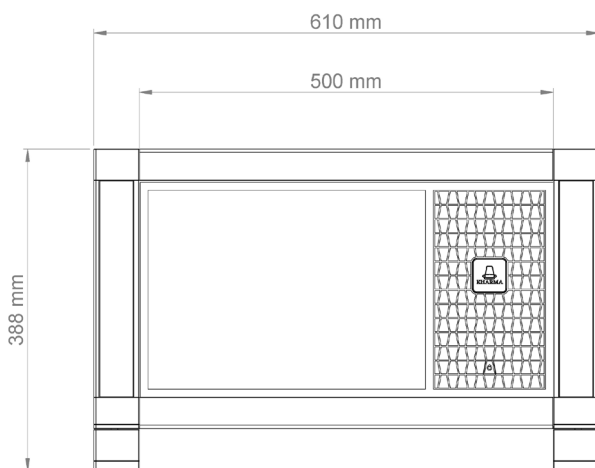

Warranty

Warranty coverage

The Kharma distributor guarantees the proper mechanical and electrical functioning of its products for a period of 5 years. Provided the warranty request card is properly filled out and sent to the address on the warranty form, including a copy of the original bill of sales. Should the customer fail to meet the three requirements mentioned above, the warranty will be limited to a period as required by national law only.

In case of malfunction the customer has to present the Kharma product in its original packing to an authorized dealer. If qualified service appears inevitable, the dealer will ship the product to an appointed service station or to the factory, depending on the required service. This warranty includes parts and labour. This warranty is not automatically transferable; subsequent owners can request a warranty at the factory.

Warranty exclusion

1. Transportation damage, visible or hidden. Damage should be reported immediately to the transport company. Registration of the complaint should be sent to the Kharma distributor previously mentioned.
2. Scratches in painted and metal surfaces. Complaints should be registered at the dealer within three days after the sale.
3. Damage due to illicit handling and inappropriate use.
4. Transportation costs to service station or factory.
5. Damage through unauthorized repair and or modification.
6. Subsequent damage to other appliances.
7. Refund of costs in case of unauthorized repair.
8. Malfunctions caused by use for commercial or professional purposes.
9. All claims on Kharma products obtained through unauthorized sources, with or without correct serial numbers.